

VOLKAN™

HIGH-EFFICIENCY INCINERATORS



waste
spectrum

VOLKAN 500E series

medium-capacity
animal carcass
incinerator

VOLKAN is a range of highly efficient incineration units for the disposal of all types of animal carcass.

They are robust, constructed using high quality materials and are available in a range of capacities and burn rates to suit every disposal problem. The VOLKAN 500E a is medium-capacity, powerful incinerator and featuring an integral after-burner is fully compliant with European legislation. It is ideal for the disposal of pigs, sheep, poultry and larger pet animal carcasses.



www.VOLKANincinerators.com

VOLKAN 500E series medium-capacity animal carcass incinerator

Why choose the VOLKAN 500E?

The VOLKAN 500E is designed specifically for the incineration of:

- Pig carcass incineration
- Sheep carcass incineration
- Larger sized pet animal carcasses
- Farm shop and abattoir waste incineration

Economic and reliable

The VOLKAN 500E is fuel efficient and easy to run, operated by automatic control systems. It is the ideal solution for medium volume incineration. Constructed from high quality materials in the UK, it comes with one year's free warranty.

Efficient and easy to use

The VOLKAN 500E is a DEFRA 'Type Approved', compact, easy to use, front-loading 500kg capacity incinerator which easily accommodates large volumes of waste. The optional trolley and winch further assists insertion of waste and once loaded, the operator selects a burn program and can leave the incinerator unattended until the waste has been reduced to ash. It is highly efficient, utilising automatic high heat-rate burners, low thermal mass linings and timer controls that ensure minimal running costs; a thermostat triggers burner shut-off when optimum temperatures are reached, increasing fuel efficiency significantly. The model is designed to use the inherent fuel properties within animal fat that aid combustion. With a burn rate of up to 50kg per hour, the incinerator retains low capacity status and requires no planning permission for farm usage. Easily installed on site, it simply requires concrete hard-standing and a 240-volt electricity & fuel supply. A comprehensive operating, care & maintenance manual is provided with each incinerator.

Cleaner emissions and legislation compliant

The VOLKAN 500E is fitted with an after-burner which is integral to the incinerator. The gas temperature reaches 850°C rapidly and is maintained until the end of the main burn cycle. This, along with highly efficient automatic burners and timer controls ensures cleaner emissions and compliance with European emissions legislation ABPR 1069/2009.

VOLKAN 500E series options

Fuel use options	Diesel LPG Natural Gas Bio Gas
------------------	---

For more information contact:
E: sales@WasteSpectrum.com
T: +44(0)1905 362100
F: +44(0)1905 362101

Why use incineration?

- Efficient, low-cost disposal
- Bio-security – no carcass transfers
- Simple on-site installation
- Controlled environmental emissions
- Low maintenance costs



VOLKAN 500E – specifications at a glance

Chamber Volume	1.20m ³
Load Capacity	up to 500 kg
Load Method	Front
Fuel Options	Diesel, LPG, Natural Gas, Bio-fuel
Electricity Supply	230 volt required
Weight	3.2 tonnes
Fuel Consumption (Typical)*	Liquid Propane Gas: 6 to 8 litres per hour Natural Gas: 7 to 9 Nm ³ /hr Diesel: 6 to 8 litres per hour
Dimensions	2.6m(l) x 1.75m(w) x 2.1m(h)

*Figures based on typical figures gained from an average burn cycle.
Waste Spectrum Environmental Ltd continually strives to improve its products and therefore reserves the right to introduce modifications to their product range without notice.

VOLKAN™

HIGH-EFFICIENCY INCINERATORS

www.VOLKANincinerators.com



VOLKAN 500E series

technical specifications

Model and Overview

VOLKAN 500E – a large-capacity, powerful incinerator, ideal for medium volume incineration.

Waste Type and Burn Rate

Designed specifically for use by poultry farmers, sheep farm owners, pig farmers, game keepers, abattoirs and for pet cremation. The incinerator will burn up to 50kg of waste per hour.

Construction

Mild steel welded fabrication consisting of sheet steel and structural section supports.

Lining

Monolithic high grade refractory concrete with high grade insulation backing.

Burner/Burners

Fully automatic, high-efficiency burners with electronic ignition, flame recognition and combustion control devices fitted.

Loading – Ash removal

Manual ash removal from the primary chamber. (Ash doors are available on request).

Exterior finish

Multi-coat high quality, high-temperature aluminium enamel top coat paint, finished in silver.

Control

Fully automatic sequential control provided by internal PLC system providing control of:

1. Secondary chamber pre-heat
2. Burn cycle (variable)
3. Cool down cycle

Fuel Options

Diesel, LPG, Natural or Bio Gas.

Typical Fuel Consumption*

Diesel: 6 / 8 litres per hour
Liquid Propane Gas: 6 / 8 litres per hour
Natural Gas: 7 / 9 Nm³ per hour

Electrical supply

240volt 16 amp.

Key Specifications

Chamber Volume 1.2m³:
1.9m (l) x 0.9m(w) x 0.7m(h)
Load Capacity up to 500kg
Burn Rate up to 50kg per hour
Load Method Front
Weight: up to 3.2 tonnes

Dimensions 2.6m(l) x 1.75m(w) x 2.3m(h)

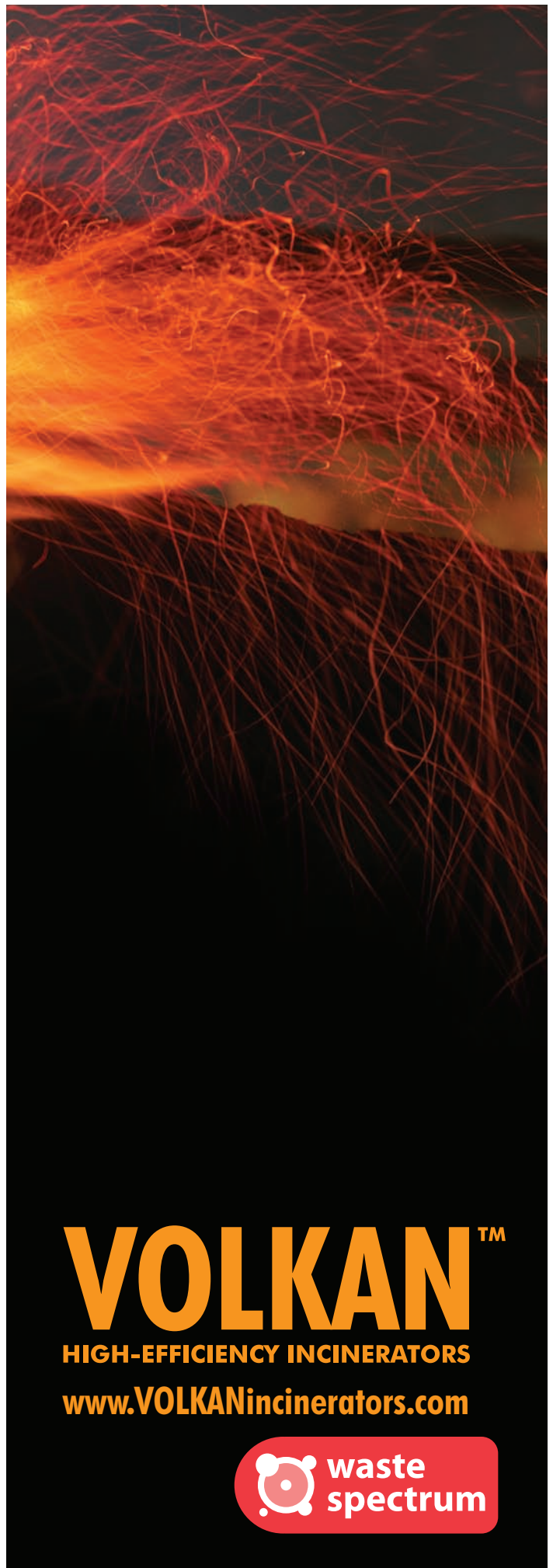

VOLKAN™

HIGH-EFFICIENCY INCINERATORS

www.VOLKANincinerators.com



**waste
spectrum**

*Figures based on typical figures gained from an average burn cycle.
Waste Spectrum Environmental Ltd continually strives to improve its products and therefore reserves the right to introduce modifications to their product range without notice.

VOLKAN™

HIGH-EFFICIENCY INCINERATORS

www.VOLKANincinerators.com



VOLKAN 500E series

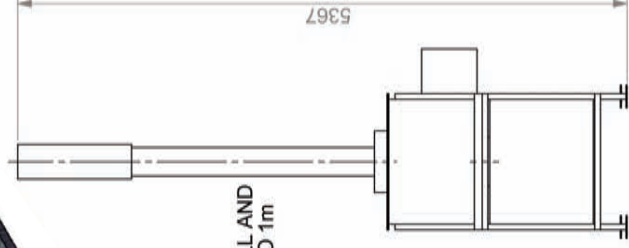
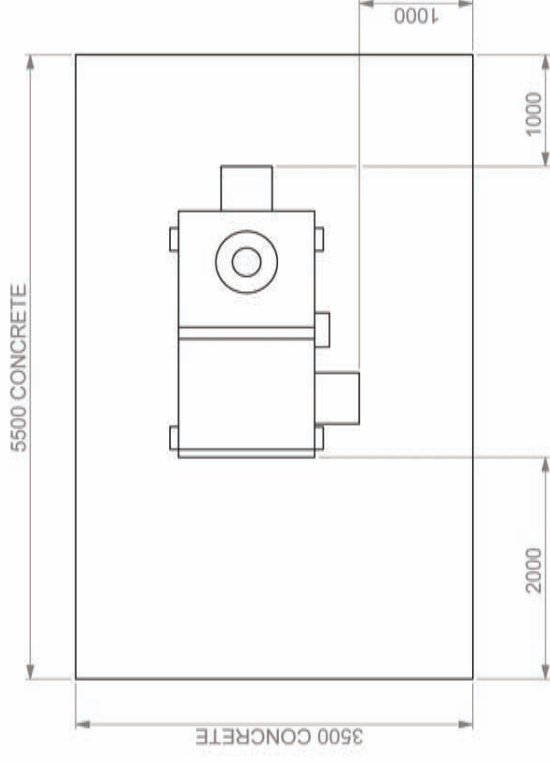
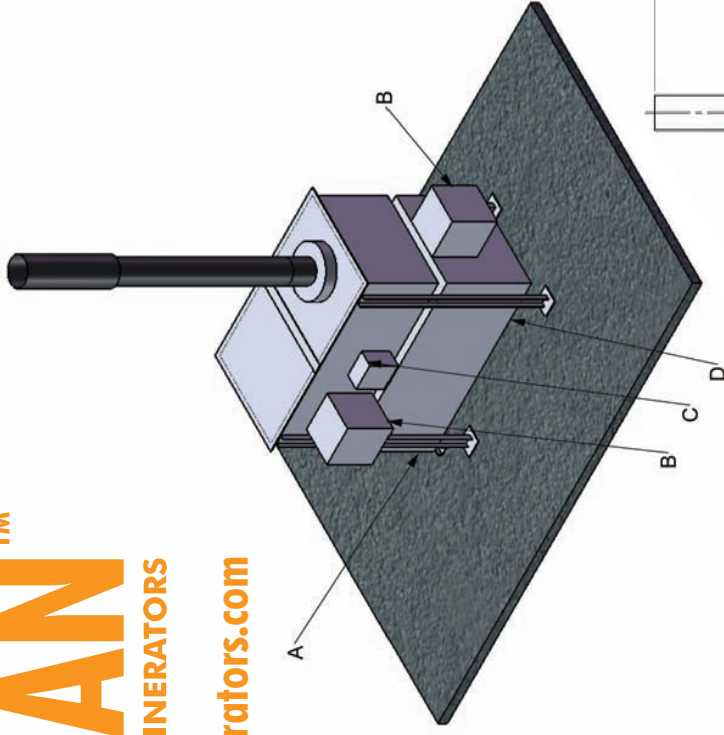

STACK IS 3m TALL AND SEPARATES INTO 1m SECTIONS

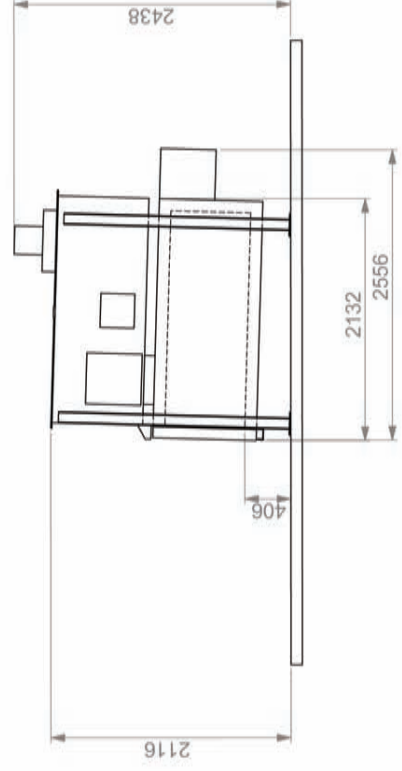

- A - LOADING DOOR DIMENSIONS - 890W x 705H
- B - BURNER POSITIONS
- C - CONTROL PANEL & ELECTRICAL CONNECTIONS
- D - DIESEL INPUT POSITION